

Eco House & Garden Srl

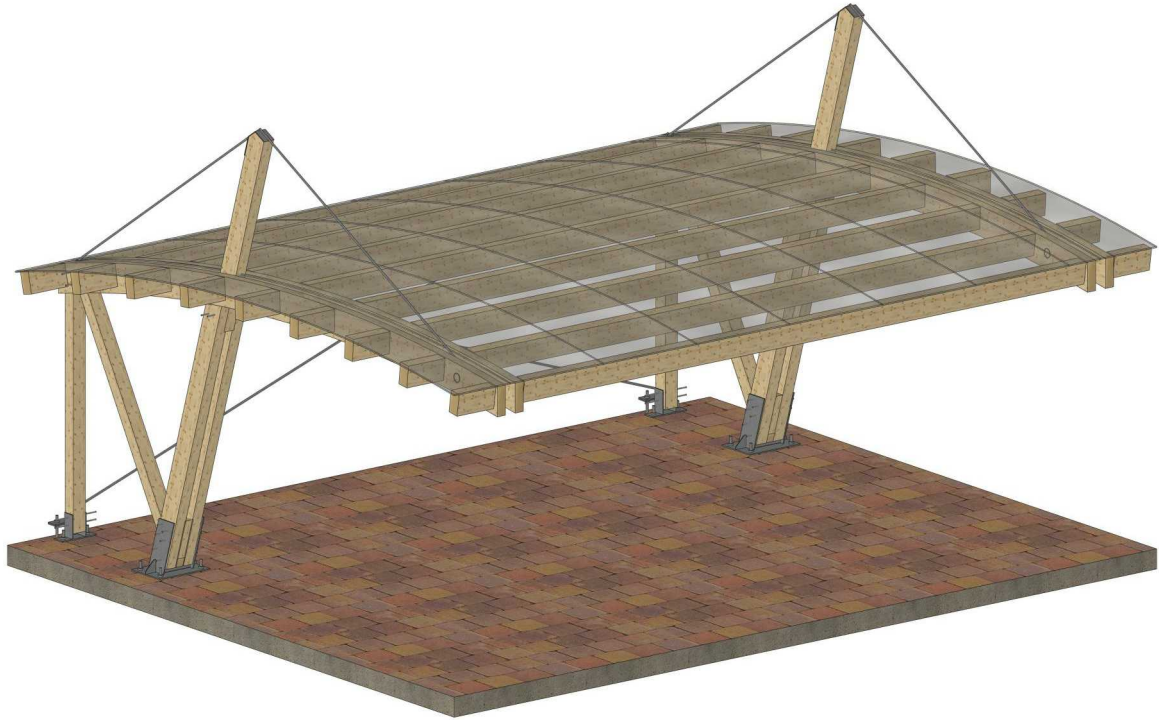

GARAJ COLIN 2

L = 678 cm

W = 550 cm

H = 370 cm

Eco House & Garden Srl

Str. Drumul Bercenarului, Nr. 2-4, Sector 4, CP .041116, București

Tel. +40 786 873 196

E-mail: office@copertine-lemn.ro / copertinelemn@gmail.com

www.copertine-lemn.ro

www.facebook.com/ecohouse.garden

Vedere transversală

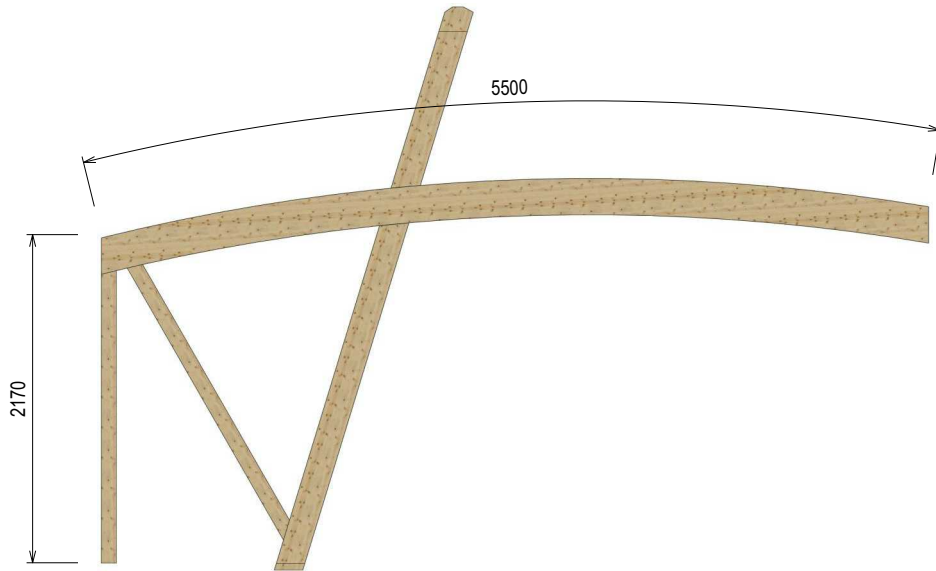

Vedere axionometrică

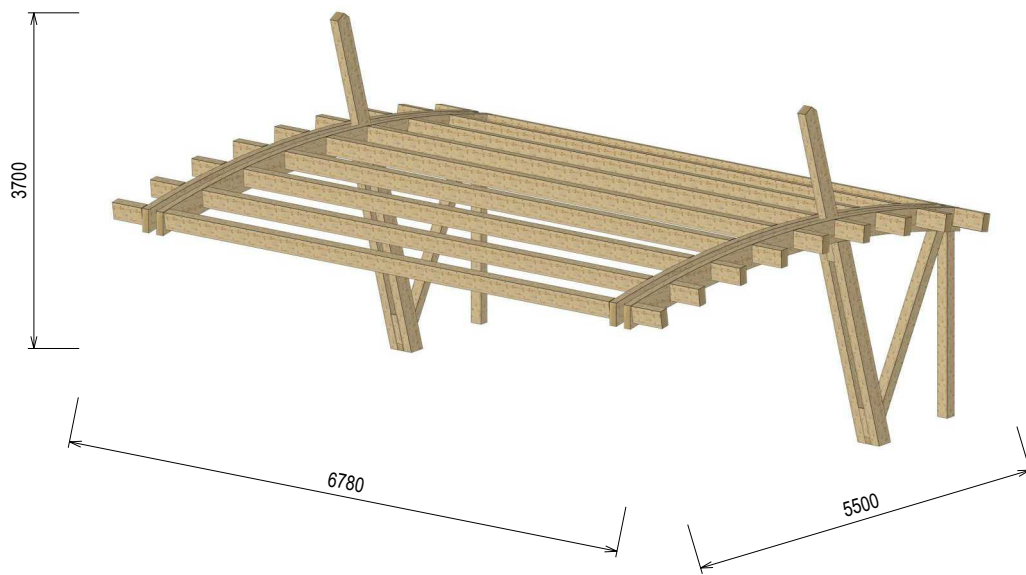

Vedere longitudinală

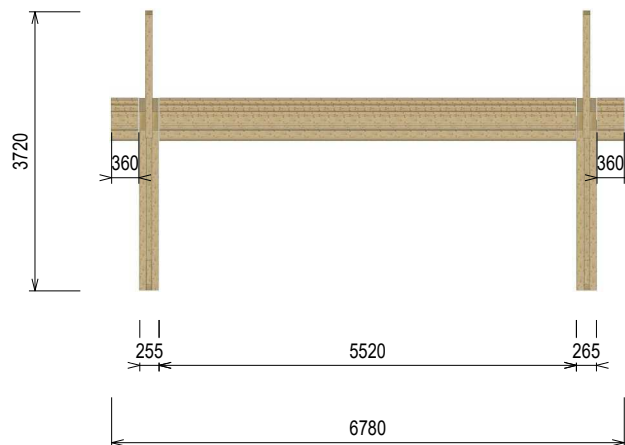

LISTĂ MATERIALE GARAJ COLIN 2

Nr. Element	Cantitate [buc]	Nume [mm]
1	2	Stâlp 1 - 100x120x2170
2	9	Traversă - 100x180x4650
3	4	Arc Colins 2 - 100x240x5500
4	4	Stâlp 2 - 100x180x2350
5	2	Stâlp intermediar 1 - 100x180x1720
6	2	Stâlp intermediar 2 - 80x180x340
7	2	Stâlp 3 - 100x120x2500
8	18	Traversă 2 - 100x180x360

LISTĂ FERONERIE GARAJ COLIN 2

Nr. Elemente	Cantitate [buc]	Nume [mm]
9	2	Papuc Metalic 1
10	12	Conexpand M10
11	2	Papuc Metalic 2
12		Tiranți
13	4	Tablă zincată 8x90x300
14	36	Tijă filetantă M12
15	4	Bolț Ø 50
16	14	Placuță metalică
17	24	Prindere LOCKT 1880
18	8	Holz-Șurub Cap Hexagonal Ø 10x100
19	24	Piuliță

Piese

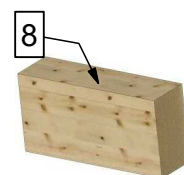
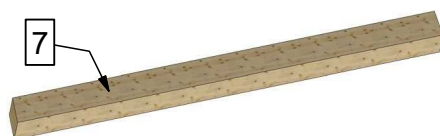
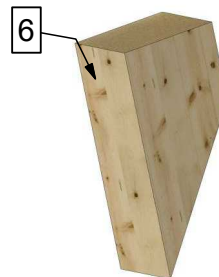
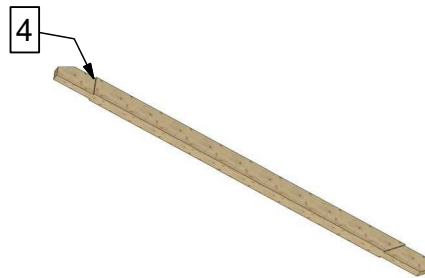

Poziționarea în fundament a papucilor metalici

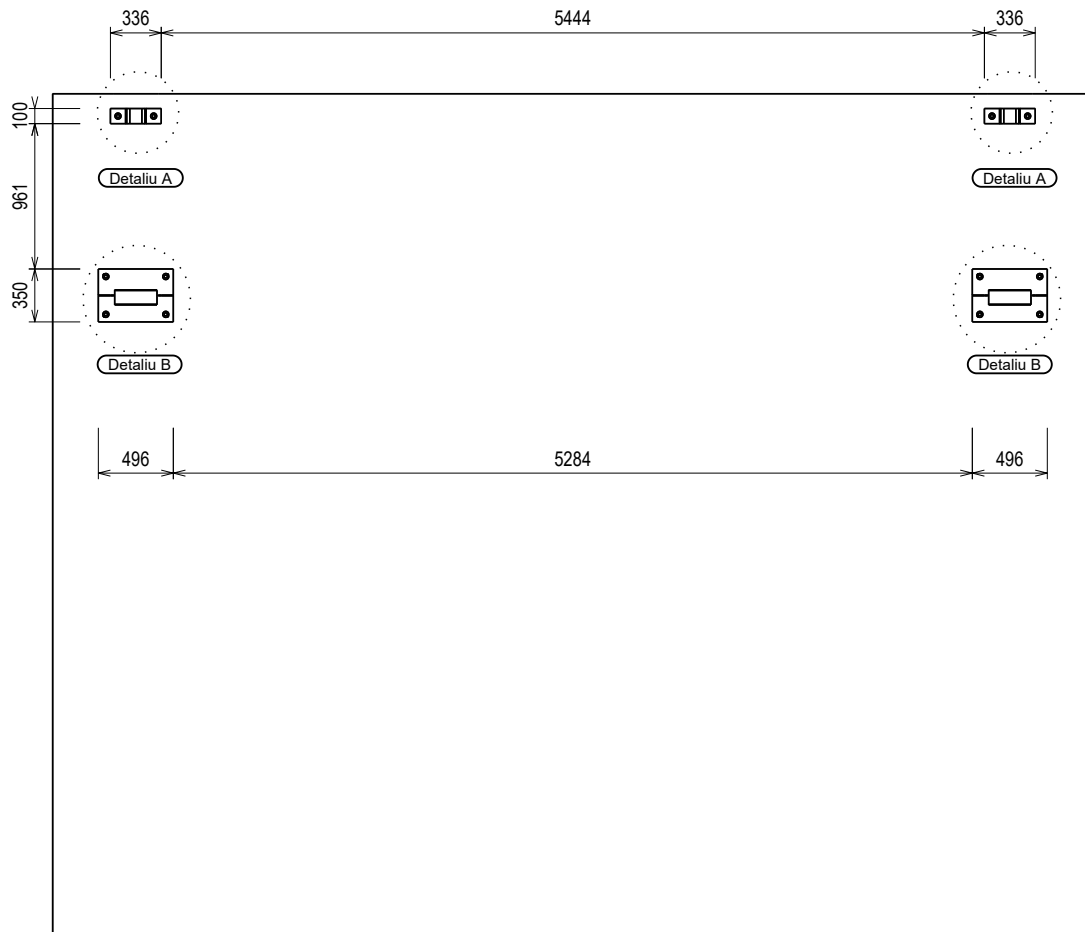

Detaliu B

Detaliu A

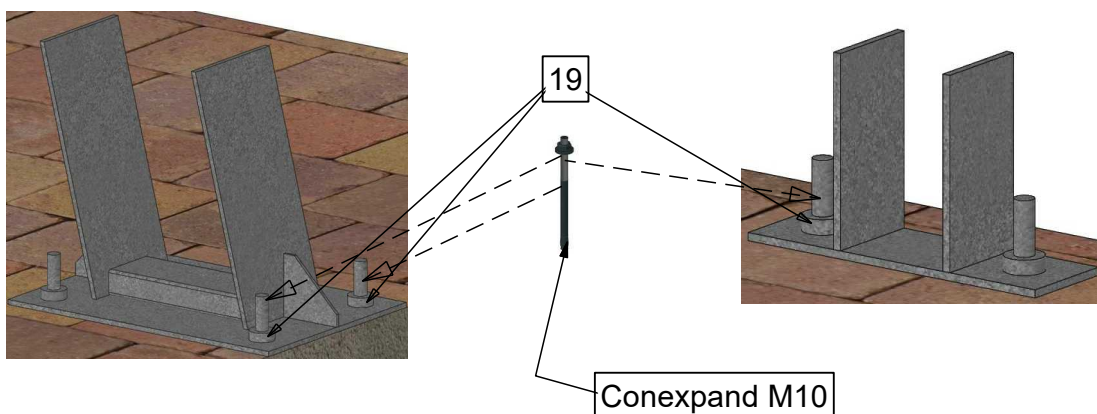

Poziționare stâlp 1 în piciorul metalic 1

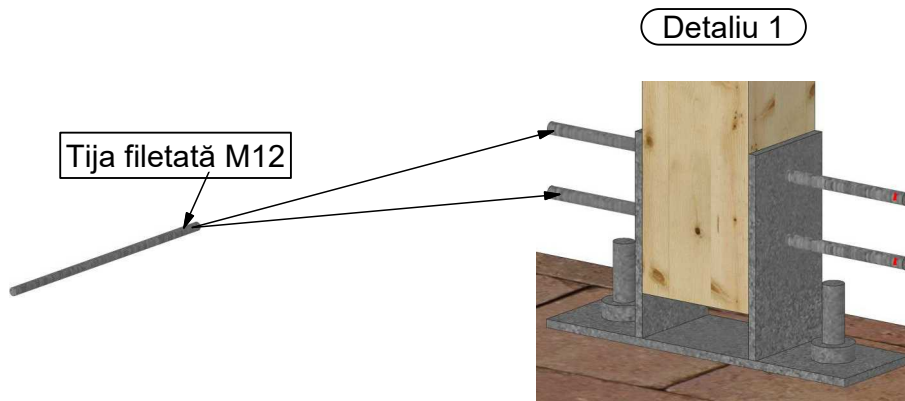
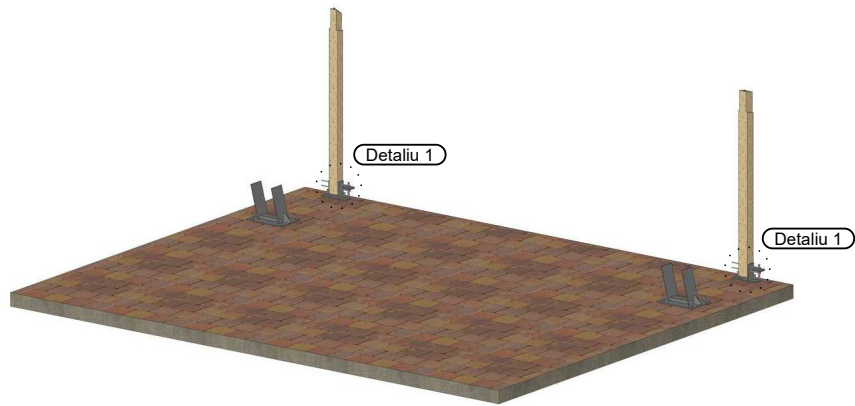

Poziționare stâlp 2 în piciorul metalic 2

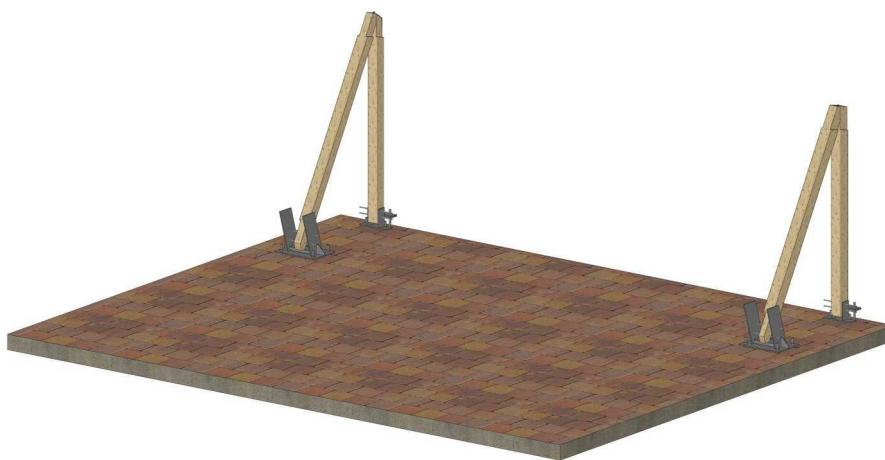

Poziționare stâlpi în piciorul metalic 2

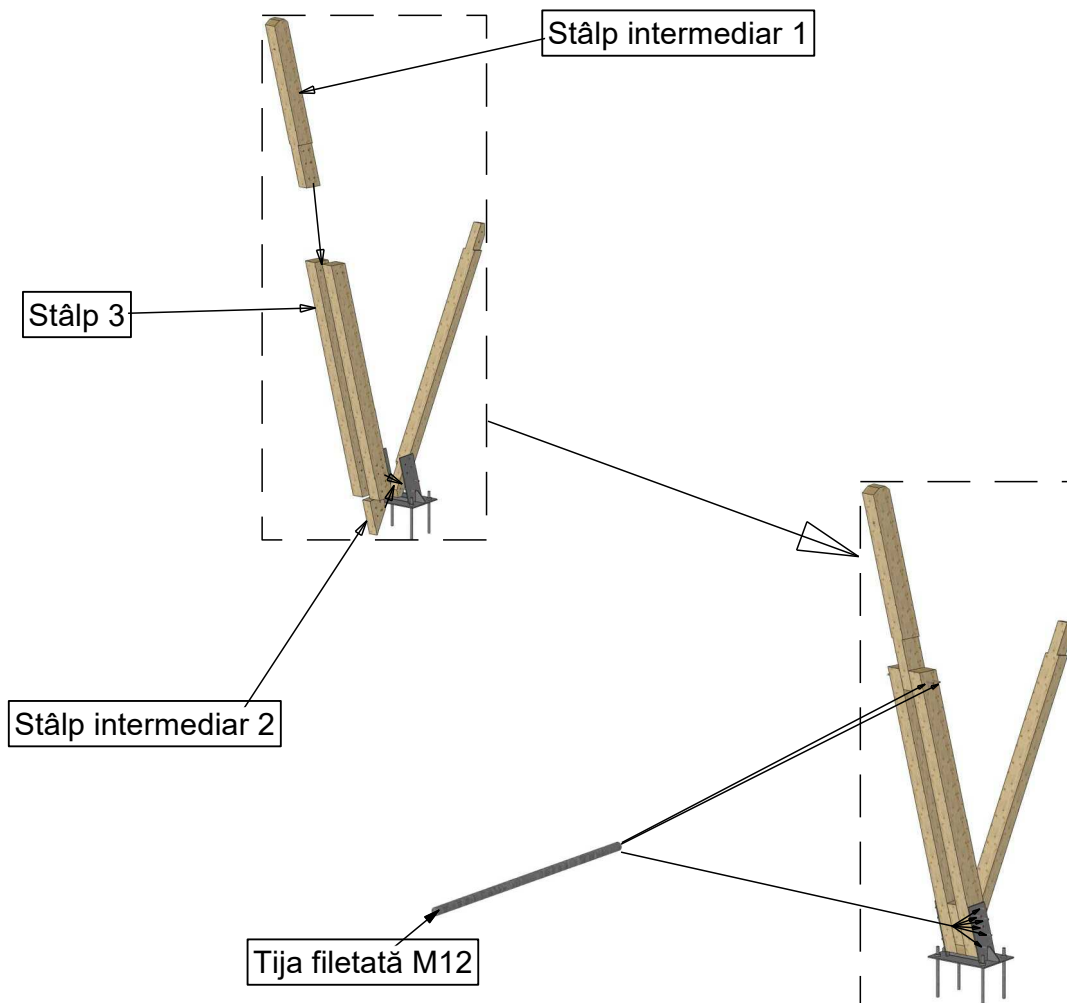

Poziționare arc Colin 2 pe stâlpi

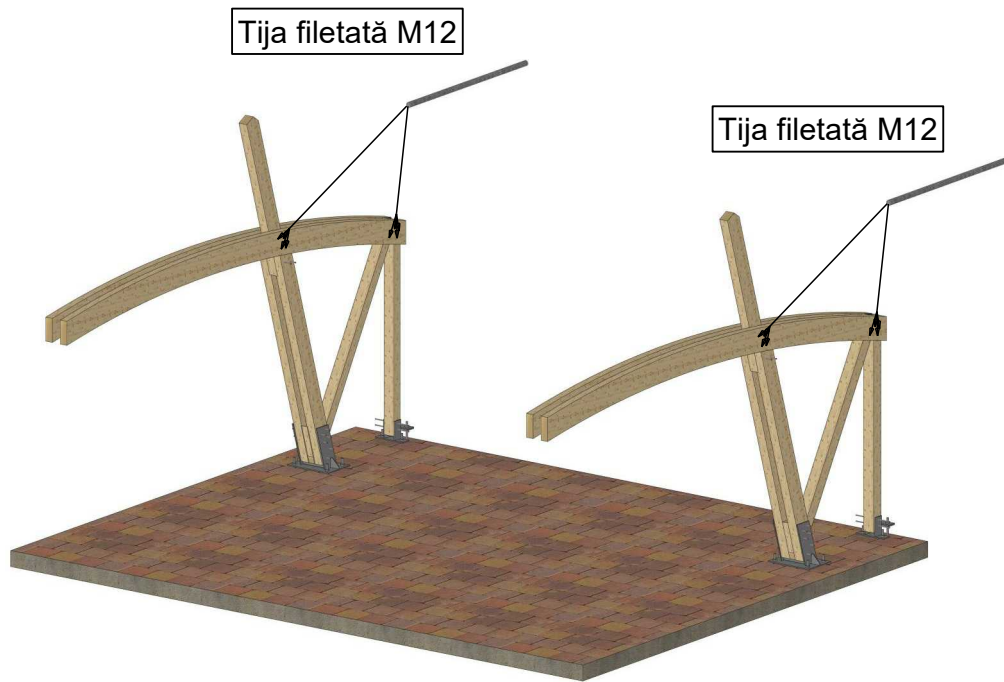

Poziționare placuțe metalice si tiranți

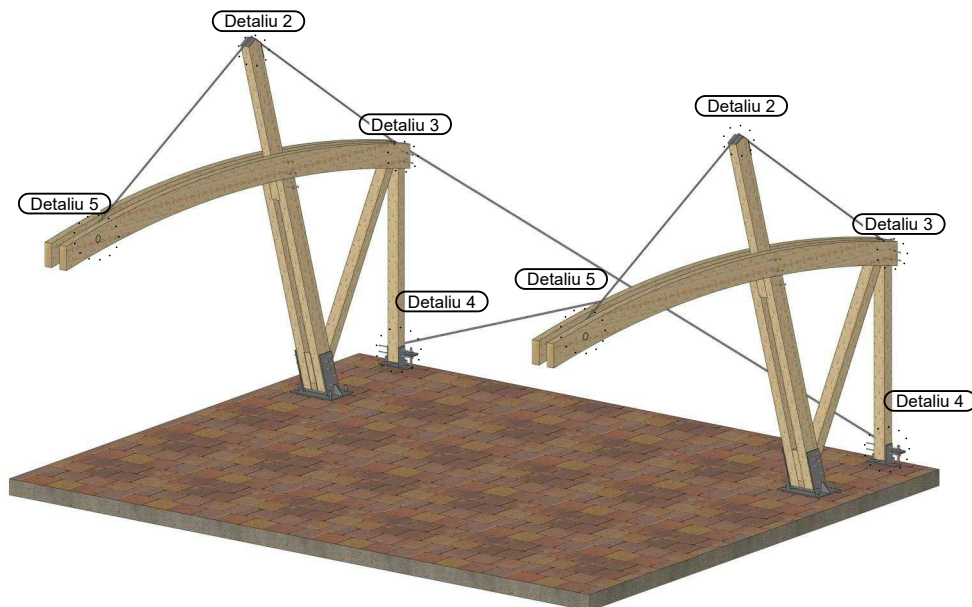

Detaliu 2

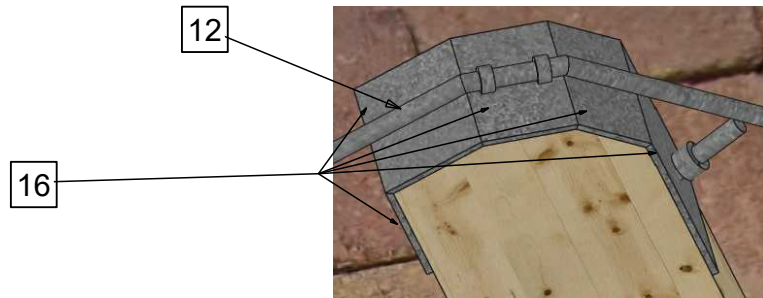

Detaliu 3

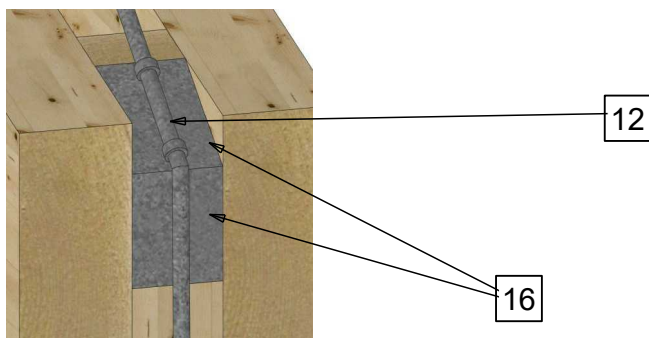

Detaliu 4

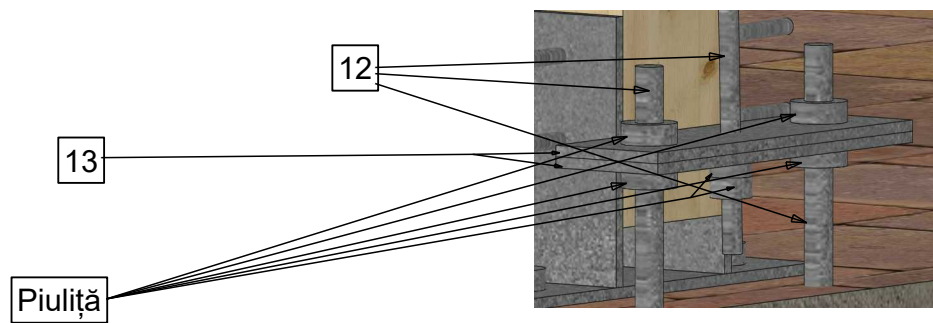

Detaliu 5

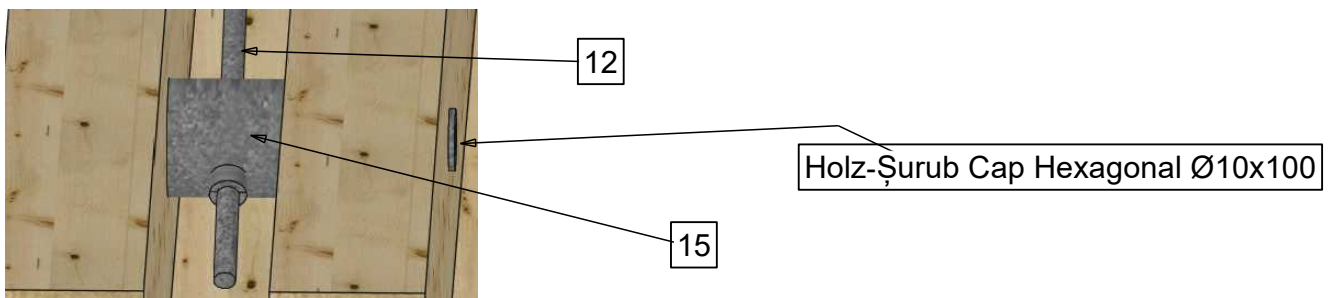

Poziționare traverse cu prinderi LOCKT

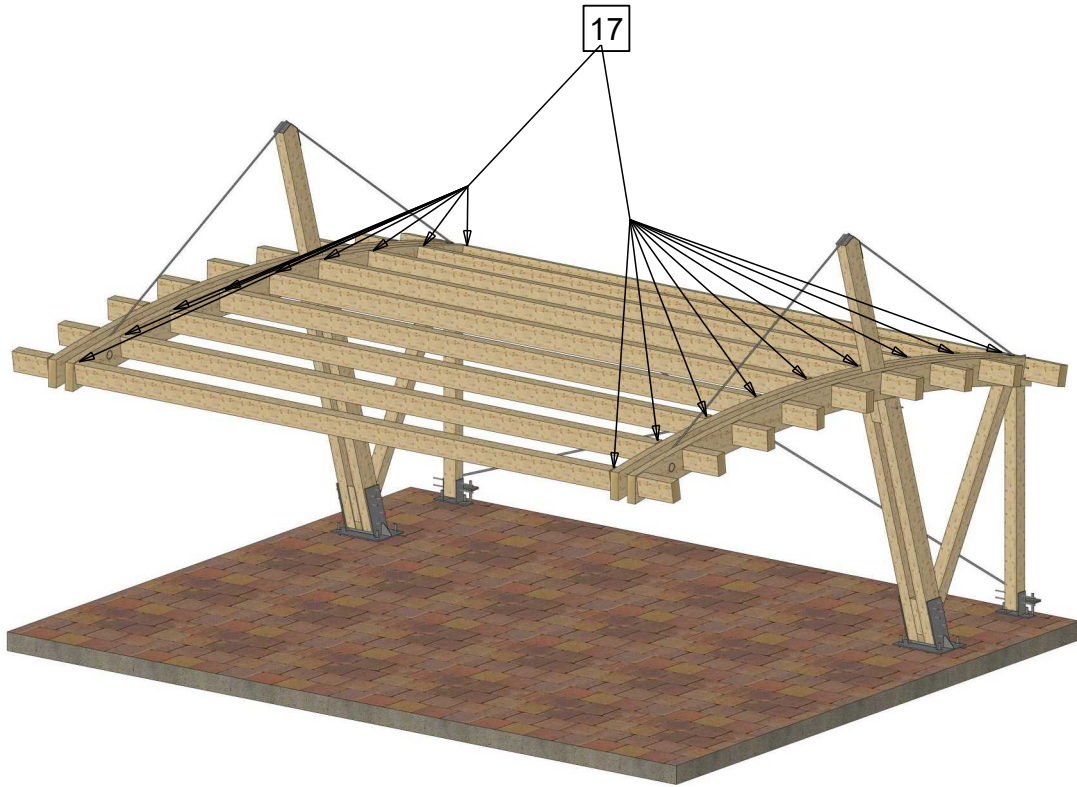

Axonometrie finală

